

X-HS M6 U27 P8 S15

386223

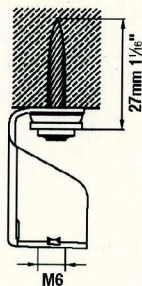
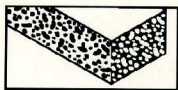

für/for/pour-

DX 460 F8

DX 351 F8

DX 36

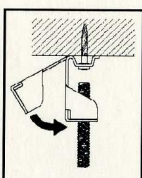
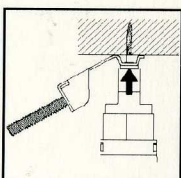
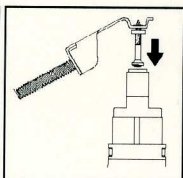
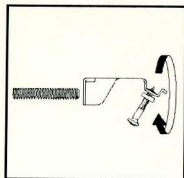

Suitable for indoor use in other than wet locations.
Suitable for maximum 3.05 m (10.0 ft) support interval. Hanger will accept 1/4-inch or 3/8-inch diameter threaded rod for support of conduit, cable, or tubing. May be used in vertical or horizontal mounting orientations to concrete and steel.
Load rating = 100 lb [Max. 2-inch EMT, RMC or IMC and Max. 3-inch SCH 40 & 80 Rigid PVC conduit].

387210