

d_s	d_o	h_1	HIT-SZ	HIT-VL	HIT-RB		d_s max.				
HZA (-R) M 12	Ø 16 mm	$l_{e, ges}$	HIT-SZ 16	HIT-VL 9/1.0	HIT-RB 16	HIT-HY200 -A, -R, -A/-R/V3 HIT-CT 1/HIT-CT 100 HIT-RE 500 V3, V4 HIT-RE 100	HZA(-R) M12 - M30	✓	≥M16: ✓ + Hilti TE-YRT		
HZA (-R) M 16	Ø 20 mm		HIT-SZ 20	HIT-VL 16/0.7	HIT-RB 20		HZA(-R) M12 - M24	✓	✗		
HZA (-R) M 20	Ø 25 mm		HIT-SZ 25		HIT-RB 25		HZA M12 - M27, HZA-R M12 - M24	✓	✓		
HZA (-R) M 24	Ø 32 mm		HIT-SZ 32		HIT-RB 32			HZA-R M12 - M24	✓	✗	
HZA M 27	Ø 35 mm		HIT-SZ 35		HIT-RB 35				HIT-RE 500 V3, V4	✓	✓
HZA M 30	Ø 40 mm		HIT-SZ 40		HIT-RB 40					HIT-RE 100	✓
HZA M 39	Ø 55 mm		HIT-SZ 55		HIT-RB 55						

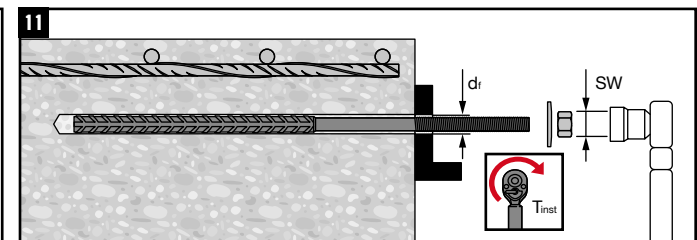

	1	2	3	4			M12		M16		M20		M24		M27	M30	M39
					HZA	HZA-R	HZA	HZA-R	HZA	HZA-R	HZA	HZA-R	HZA	HZA	HZA		
HIT-HY 200-A	21	10	11/0493	EAD 330499-01	/	h_{ref}	70-220	70-140	80-300	80-220	90-380	90-300	100-480	100-400	120-540	/	/
	21	5	11/0492	ETAG 001-1,-5	/	l_o	20	100	20	100	20	100	20	100	20	/	/
HIT-HY 200-R	21	11	12/0084	EAD 330499-01	/	h_{ref}	70-220	70-140	80-300	80-220	90-380	90-300	100-480	100-400	120-540	/	/
	22	6	12/0083	EAD 331522-00	/	l_o	20	100	20	100	20	100	20	100	20	/	/
HIT-HY 200-A/-R V3	24	56	19/0601	EAD 330499-02	/	h_{ref}	70-220	70-140	80-300	80-220	90-380	90-300	100-480	100-400	120-540	/	/
	23	55	19/0600	EAD 330087-01	/	l_o	20	100	20	100	20	100	20	100	20	/	/
HIT-HY 200-A/-R	21	42	18/0837	EAD 330499-00	/	h_{ref}	/	/	80-300	80-220	90-380	90-300	100-480	100-400	120-540	/	/
						l_o			20	100	20	100	20	100	20		
HIT-CT 1	21	29	11/0390	EAD 330087-00	/	l_o	70-780	70-700	80-1280	80-1200	90-1280	90-1200	100-1280	100-1200	120-1280	/	/
HIT-CT 100	24	82	24/0147	EAD 330087-01	/	l_o	70-680	70-600	80-680	80-600	90-680	90-600	100-680	100-600	/	/	/
						h_{ref}	20	100	20	100	20	100	20	100	20		
HIT-RE 500 V3	23	23	16/0143	EAD 330499-01	/	h_{ref}	70-220	70-140	80-300	80-220	90-380	90-300	100-480	100-400	120-540	/	/
	21	22	16/0142	EAD 331522-00	/	l_o	20	100	20	100	20	100	20	100	20	/	/
						h_{ref}	70-780	70-700	80-1280	80-1200	90-1280	90-1200	100-1280	100-1200	120-1280	/	/
	21	40	18/0745	EAD 332077-00	/	l_o	20	100	20	100	20	100	20	100	20	/	/
h_{ref}						70-220	70-140	80-300	80-220	90-380	90-300	100-480	100-400	120-540	/	/	
HIT-RE 500 V4	23	67	20/0540	EAD 330087-01	/	l_o	70-780	70-700	80-1280	80-1200	90-1280	90-1200	100-1280	100-1200	120-1280	/	/
	22	66	20/0541	EAD 330499-02	/	h_{ref}	20	100	20	100	20	100	20	100	20	/	/
HIT-RE 100	23	20	15/0882	EAD 330499-00	/	h_{ref}	/	70-140	/	80-220	/	90-300	/	100-400	/	/	/
						l_o		100		100		100		100			

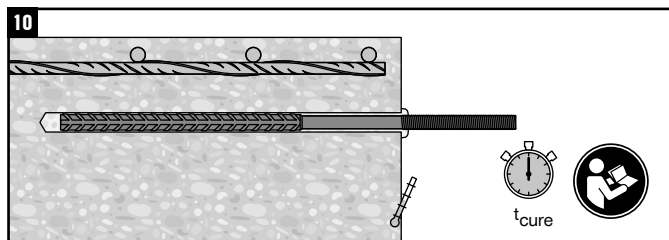
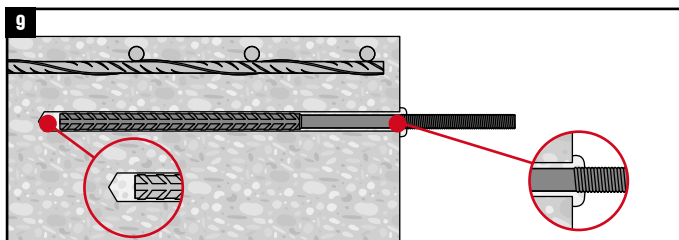
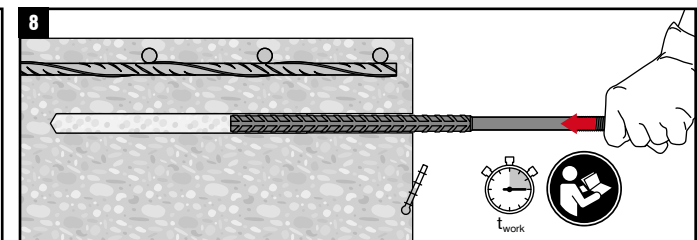
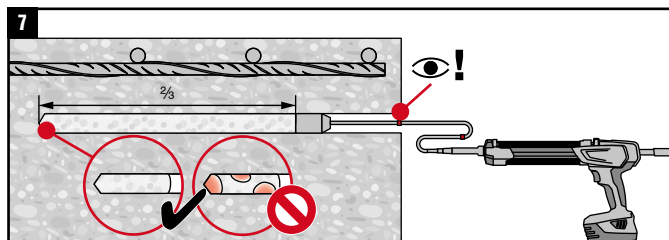
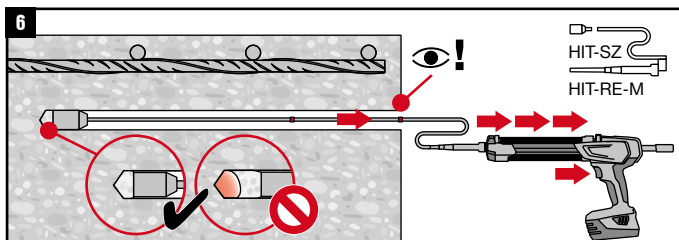
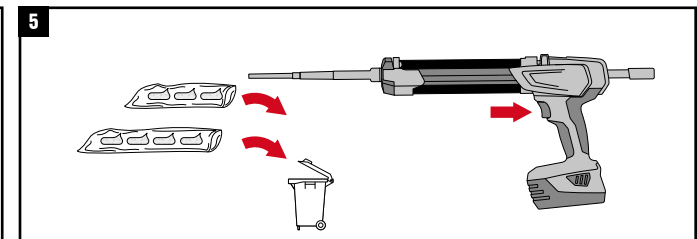
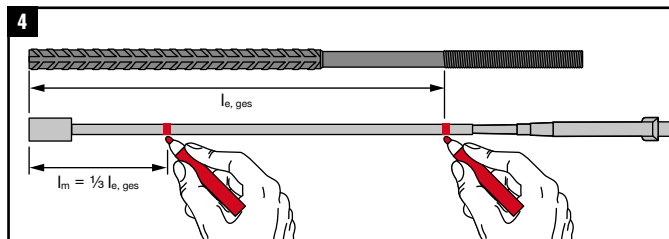
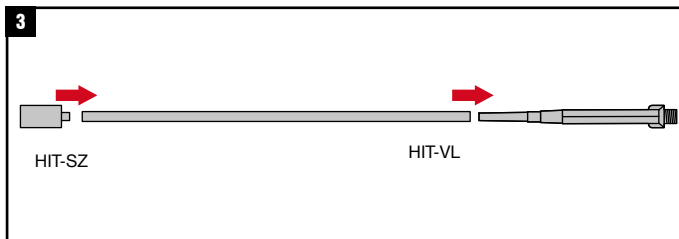
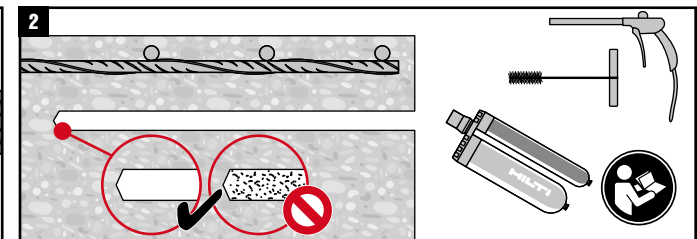
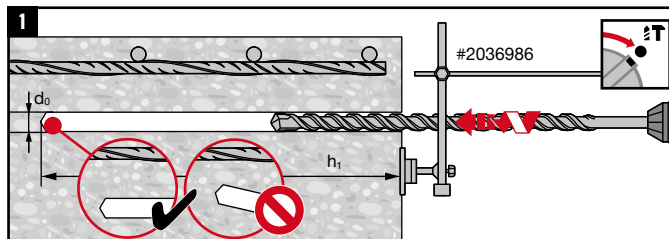
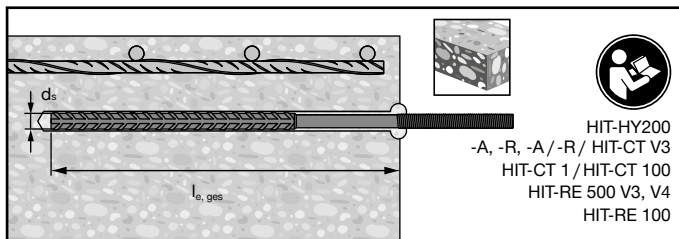
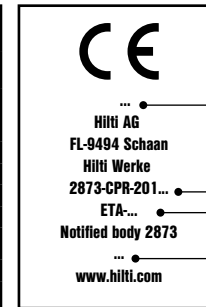

	d_s	d_f	SW	T_{inst}
HZA (-R) M 12		Ø 14 mm	19	0 ... 40 Nm
HZA (-R) M 16		Ø 18 mm	24	0 ... 80 Nm
HZA (-R) M 20		Ø 22 mm	30	0 ... 150 Nm
HZA (-R) M 24		Ø 26 mm	36	0 ... 200 Nm
HZA M 27		Ø 30 mm	41	0 ... 270 Nm
HZA M 30		Ø 33 mm	46	0 ... 300 Nm
HZA M 39		Ø 42 mm	60	0 ... 390 Nm

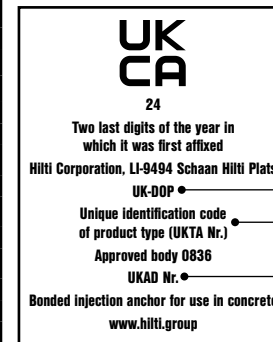
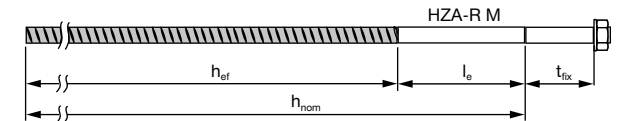

1	2	3
UK 0836-CPR-22/P6578	UKTA-22/6577	UKAD 330087-00-0601
UK 0836-CPR-22/P6581	UKTA-22/6580	UKAD 330499-01-0601
UK 0836-CPR-22/P6570	UKTA-22/6569	UKAD 330087-00-0601
UK 0836-CPR-22/P6572	UKTA-22/6571	UKAD 330499-01-0601
UK 0836-CPR-23/P6703	UKTA-23/6692	UKAD 330499-01-0601